

**Dimensions
 Standard Flange**

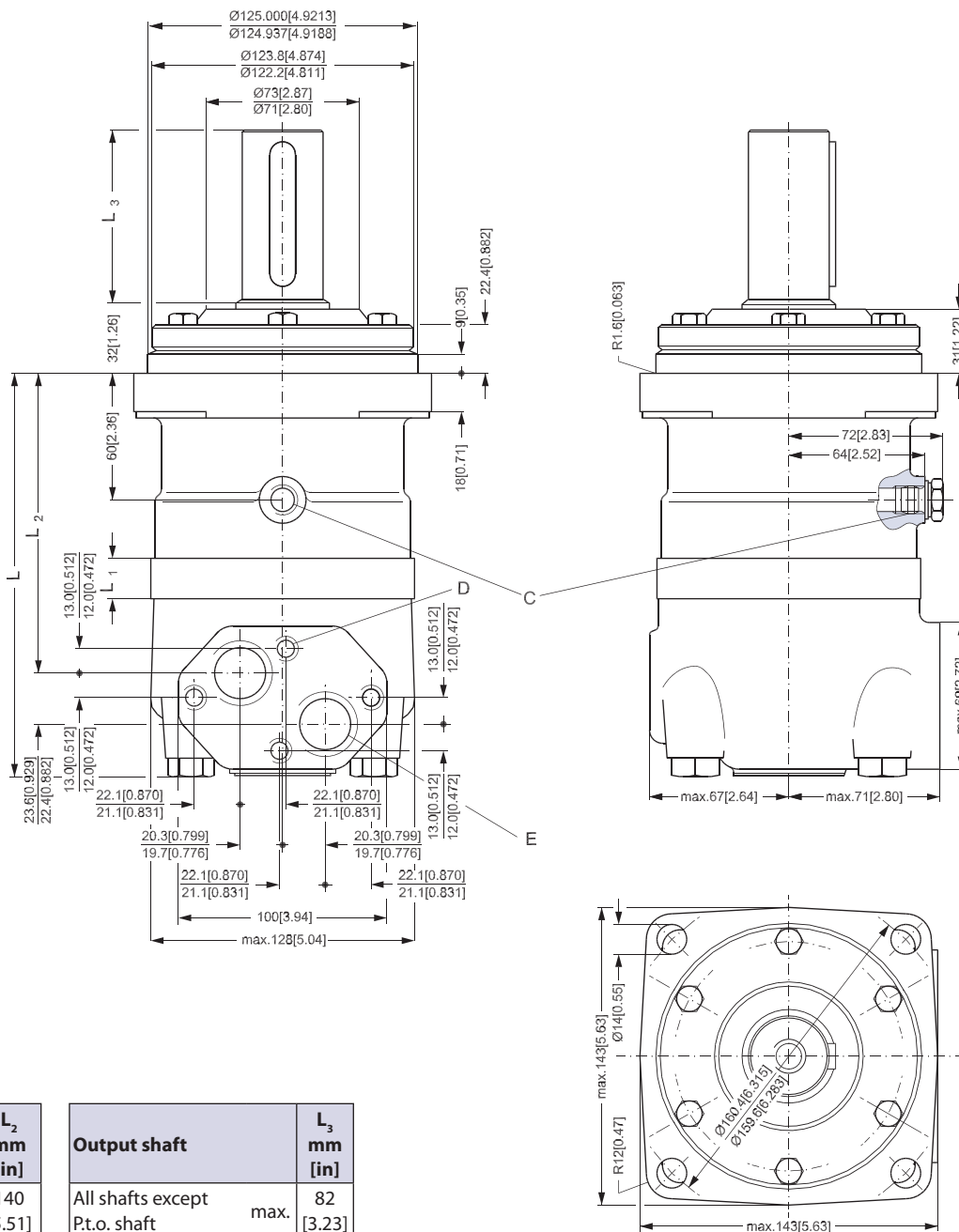

Type	L _{max} mm [in]	L ₁ [*] mm [in]	L ₂ mm [in]
OMT 160	190 [7.48]	16.5 [0.650]	140 [5.51]
OMT 200	195 [7.68]	21.5 [0.846]	145 [5.71]
OMT 250	201 [7.91]	27.8 [1.094]	151 [5.94]
OMT 315	211 [8.31]	37.0 [1.457]	161 [6.34]
OMT 400	221 [8.70]	47.5 [1.870]	171 [6.73]

Output shaft	L ₃ mm [in]
All shafts except P.t.o. shaft	max. 82 [3.23]
P.t.o. shaft	max. 102 [4.02]

- C: Drain connection
G 1/4; 12 mm [0.47 in] deep
- D: M10; 10 mm [0.39 in] deep
- E: G 3/4; 17 mm [0.67 in] deep

*) The gearwheel set is 3.5 mm

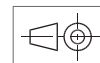

Shaft Version

- A: Cylindrical 40 mm shaft
- C: Parallel key
A12 × 8 × 70
DIN 6885
Keyway deviates from standard

